

Product Name: Segue
Process: Colossus 8-Color
Material: Poly Knit 9
Effective Date: 6/27/2011

Backwall Tension Fabric Graphic (Included)

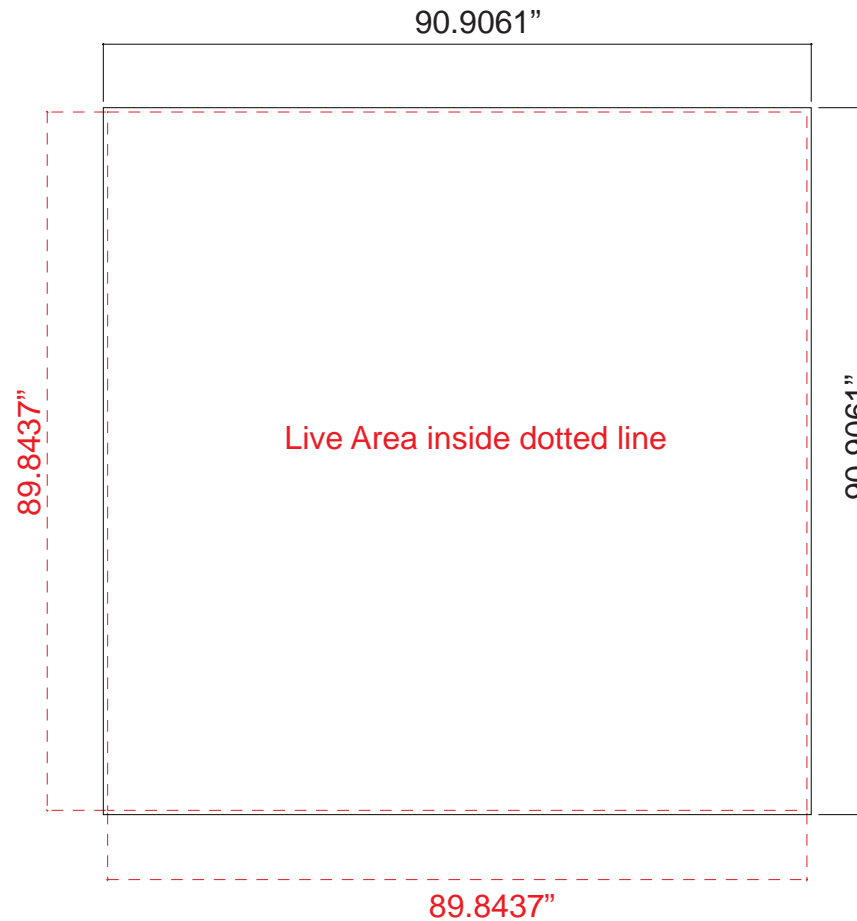

Finished Size: 90.9061"w x 90.9061"h  
Live Area: 89.8437"w x 89.8437"h

**NOTE:** Graphic files must be @ 150 dpi Finished Size.  
**DO NOT** send Flattened Files. Production can not manipulate  
the content, proportion or color of these files.

Backwall Tension Fabric Graphic

Product Name: Seque
Process: Direct Print Graphic
Material: 1/4" Sintra Substrate
Effective Date: 6/27/2011

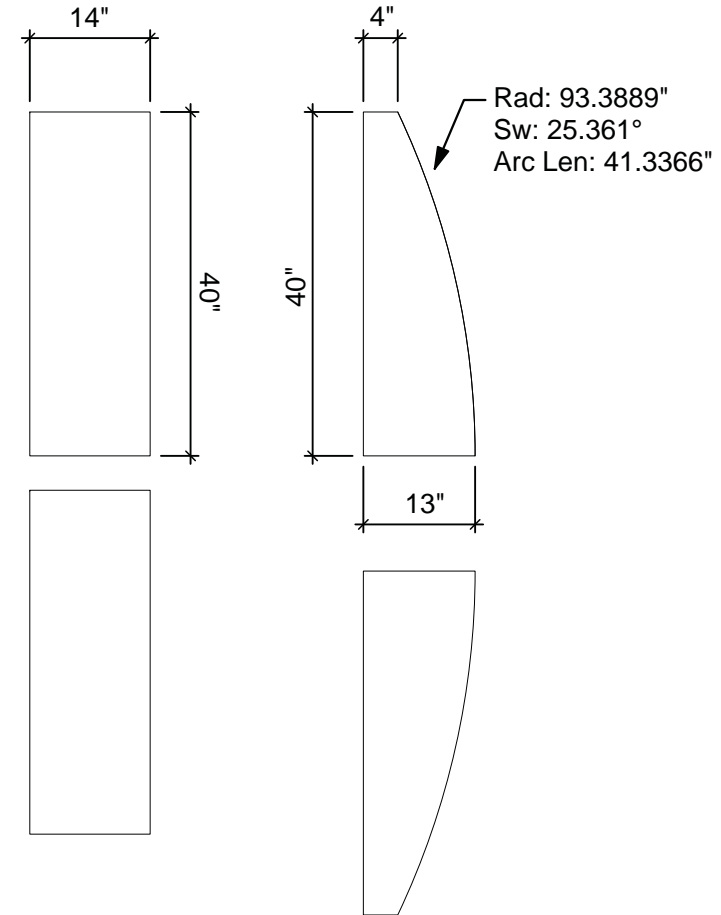
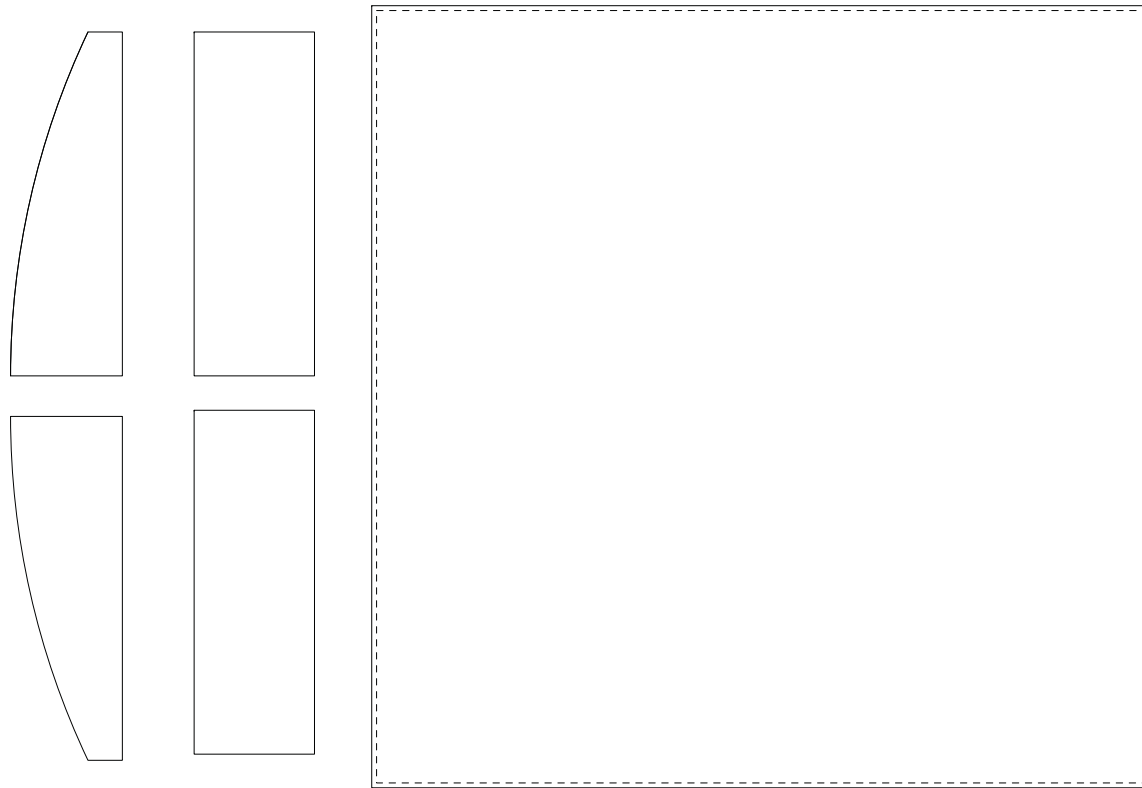

**NOTE:** Graphic files must be @ 150 dpi Finished Size.  
**DO NOT** send Flattened Files. Production can not manipulate  
the content, proportion or color of these files.